

entry/exit of cables : from PC, AC power,  
pedals, etc...  
via 2 grommets diameter 60mm

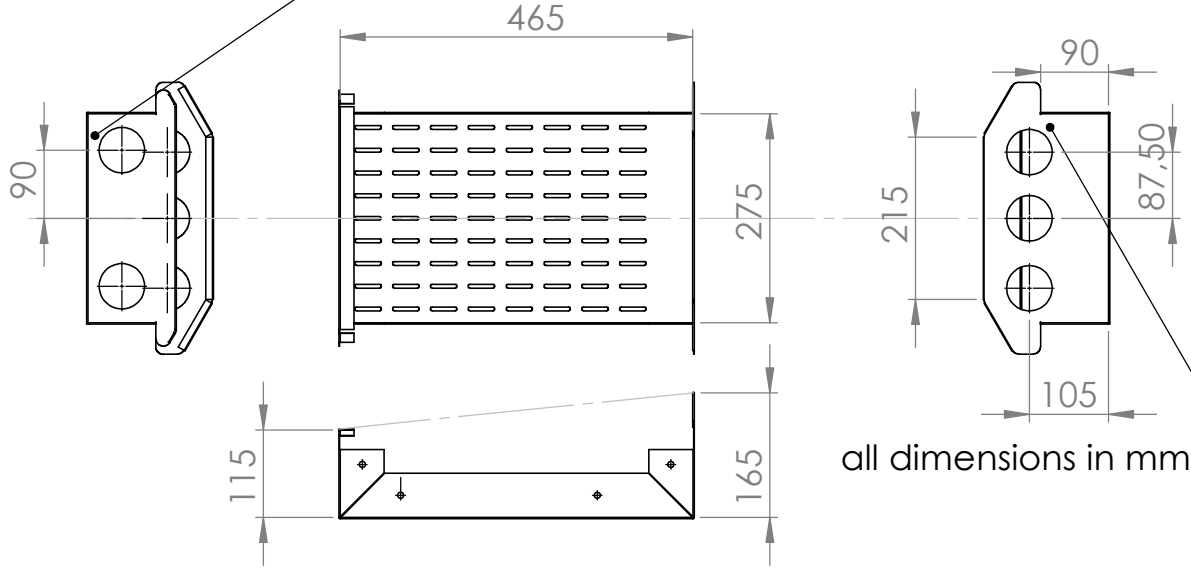

entry/exit of cables : from wheel, screens, etc...  
via 2 grommets diameter 60mm and one  
USB/Headset 60mm grommet

all dimensions in mm

Dimensions of the **FSIM**  
"motor Compartment"  
use it to install PS, XBox or Slim PC  
or just USB hub, Multiplug  
and cable management

